

# Mossberg Model 4M4-D Scope Sight

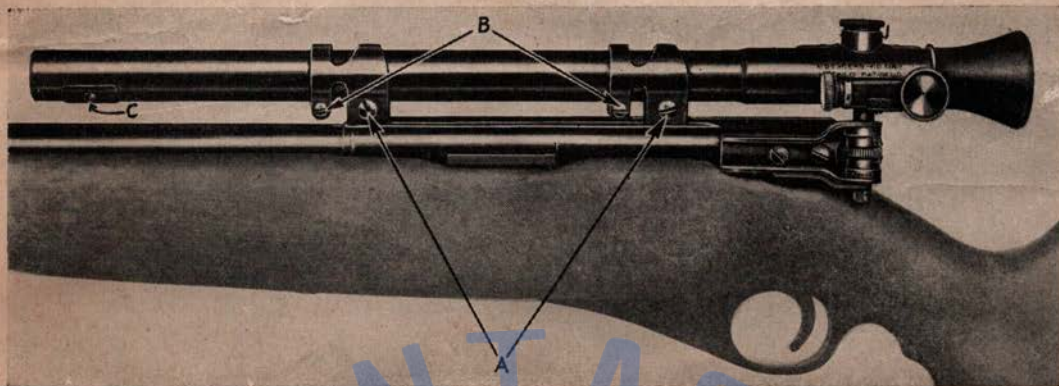

## Features

1. Four power magnification.
2. Wide field of view, approximately 20 feet at 100 yards.
3. Fine Click adjustments for both windage and elevation give one minute adjustments at 100 yards.
4. Medium fine cross hair, .001" hairs.
5. Five lens optical system gives good illumination and clear definition without distortion or objectionable color fringe.
6. Cross hair reticule moves in flat plane both horizontally and vertically.
7. External adjustment for obtaining sharp definition of cross hair reticule.
8. Strong rigid mount dovetailed directly to receiver.
9. Will not lose or change its adjustment when removed and replaced.
10. Easy to attach.
11. Easy to adjust eye relief.

## INSTRUCTIONS FOR MOUNTING MODEL 4M4 TELESCOPE SIGHT

The Model 4M4 telescope sight is designed especially for the Mossberg Model 151M rifle which has a dovetailed cut on top of the receiver in which this special scope mount fits.

**TO MOUNT TELESCOPE** — Loosen the Clamp and Binding Screws "A" and "B", then slide the clamps into the dovetail grooves in the receiver pushing the rear clamp back to within  $\frac{1}{2}$  inch from the very end of groove and the front clamp even with the front end of the receiver, as shown above. Then tighten clamp screws "A" slightly (not hard enough but what the telescope tube can be moved, as the clamp screws bind on the scope tube as well as the receiver). Next slide the telescope tube backward and forward to obtain the proper eye relief (distance between the eye and end of scope) which should be about 2 inches. Be sure the cross hairs are vertical and horizontal before tightening the telescope clamp screws "A", then tighten binding screws "B".

**TO REMOVE TELESCOPE** — Loosen clamp screws "A" only and slide off receiver.

## INSTRUCTIONS FOR SIGHTING — IN MODEL 4M4 TELESCOPE SIGHT

To adjust the focus, loosen the Focus Adjusting Screw "C", and slide the Focus Adjusting Plate backward or forward until the object becomes sharp and clear and then tighten the Focus Adjusting Screw "C". To adjust the cross hairs, loosen the two screws that hold the plate on the rear end of the scope and slide the plate backward or forward until the cross hairs are sharp and clear and then tighten the screws. These adjustments are rarely necessary as the scope is perfectly adjusted at the factory for normal vision.

Pace off 25 yards and set up a paper target with a bulls-eye in the center. Use a sand bag or steady rest and fire at the target. If the shots are low, turn the elevation adjustment screw counter clock-wise. If the shots are high turn the elevation screw clock-wise. If the shots are to the left turn the windage screw counter clock-wise. If the shots are to the right turn the windage screw clock-wise. At 25 yards each click changes the point of impact of the bullet  $\frac{1}{4}$  inch. At 100 yards this change would be one inch.

This scope comes equipped with a low clamp which is marked "L" and which is fitted in the forward position. If the rifle should shoot too high and you are unable to make the proper adjustments by turning the elevation screw up, take the low clamp off front and put it in the rear position. There is no adjustment for windage except by the windage screw.

**O.F. Mossberg**  
NEW HAVEN 5, CONN. & SONS, INC.

# PARTS LIST - MOSSBERG MODEL AM-4-D

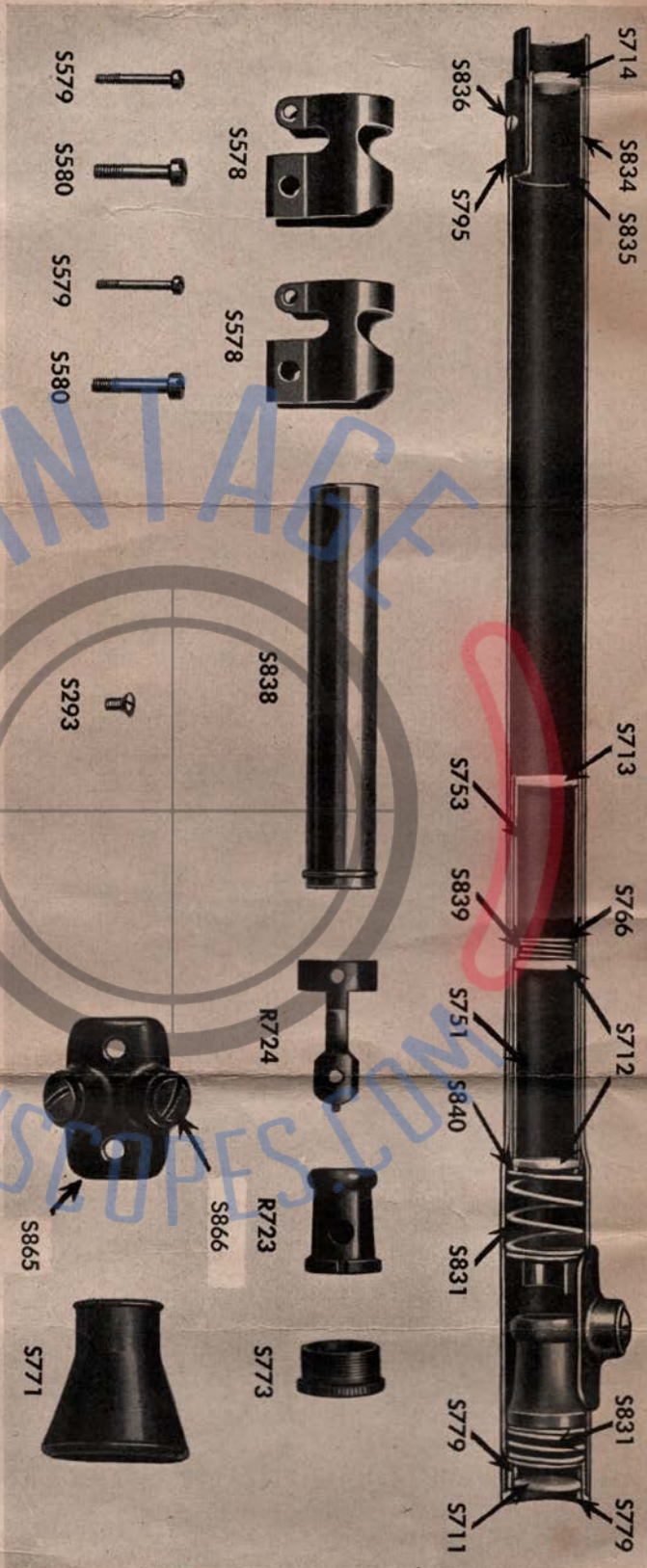

Part No.	Name	Price Each	Part No.	Name	Price Each
S293	Adjustment Base Screw	\$.15	S795	Focus Adjusting Plate	.15
S306	Mount Complete	1.50	S831	Retaining Spring	.15
S578	Clamp	.70	S834	Objective Tube	.55
S578-L	Clamp	.70	S835	Lens Retaining Sleeve	.30
S579	Telescope Binding Screw	.15	S836	Focus Adjusting Screw	.15
S580	Clamp Screw	.15	S837	Eye Piece Tube Complete, includes S 818, S 839, S840	2.80
S711	Lens, Ocular	1.00	S838	Eye Piece Tube only	.15
S712	Lens, Field	1.00	S838	Eye Piece Tube only	2.80
S713	Lens, Objective	1.00	S839	Spacer Spring	.15
S714	Lens, Objective	1.00	S840	Lens Retainer	.15
S751	Spacer, 1-15/32"	1.15	S865	Adjustment Base	2.50
S753	Spacer, 1-27/32"	1.15	S866	Widening Elevation Screws	.50
S766	Aperture D,yce	.40	S876	Outsize Tube	.70
S771	Eye Piece Bushing Complete, includes S773, S711, S779(2)	1.00	R723	Reticule	1.75
S772	Eye Piece Bushing	.40	R724	Reticule Bracket	.30
S773	Eye Piece Bushing	1.00			
S779	Lens Retainer	.30			

No Order Accepted Under 35 Cents

## FACTORY REPAIR CHARGES

**CAUTION - A TELESCOPE SIGHT IS A PRECISION INSTRUMENT. DO NOT ATTEMPT TO REPAIR IT YOURSELF** unless you are thoroughly familiar with optics. Return your telescope sight to us for repair. Ship the scope prepaid and attach a letter to the outside of the package enclosing instructions and remittance to cover the service charge.

**We will:**

- furnish and install 1 lens ..... 2.00
- furnish and install 2 lens ..... 2.50
- furnish and install 3 lens ..... 3.00
- furnish and install 4 lens ..... 3.50
- furnish and install 5 lens ..... 4.00
- furnish and install cross hair reticule ..... 2.40
- clean and reassemble scope ..... 1.25
- refinish mount ..... 2.00
- clean, refinish, reassemble scope and refinish mount ..... 2.70

We will fit any other part to your scope for the cost of the part plus return postage. Prices of Parts include transportation charges.